

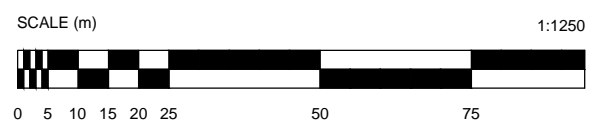

GENERAL NOTE
 This drawing is to be read in conjunction with all other relevant drawings, schedules and specifications issued by Floorplanz Ltd.
 All interior dimensions including ceiling heights are taken to and from finished surfaces unless otherwise stated. All levels and dimensions must be checked on site.
 Any discrepancies with the information depicted in this drawing must be reported in writing to Floorplanz Ltd. Responsibility can not be accepted for alterations made to this drawing without prior permission from Floorplanz Ltd.
 This drawing must not be photocopied, scaled or reproduced otherwise scale accuracy can not be guaranteed.
 This drawing should not be used in any circumstances for any structural calculation or building construction / demolition work.



Land Registry Note
 This drawing has been created in accordance with the Land Registry Practice Guide 40.
 Any colouring, shading or wording detailed on the plan are not the responsibility of Floorplanz Ltd.

= Extent of demised premises
 = Communal area

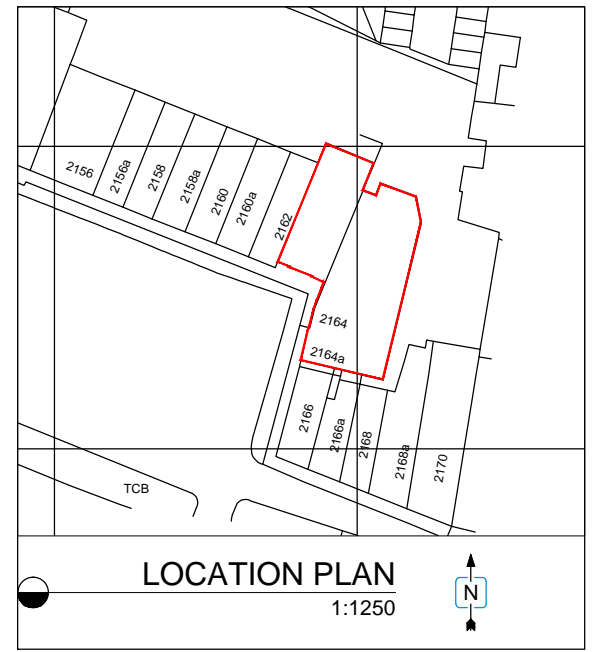

SITE GROUND FLOOR,
 COVENTRY ROAD, SHELDON,
 BIRMINGHAM,
 B26 3JB

TITLE

LAND REGISTRY PLAN

SCALE ON A3 1:1250	DRAWN AF	CHECKED BB
1:200	FPZ	DATE
212563	LR	11.06.2018

GROUND FLOOR
1:200